

LINEAR

Quick Installation Guide

LNVR1-08P / LNVR1-16P



Warning Before Installation

- Power off the Network Video Recorder if you detect abnormal smell or smoke coming from it.
- Do not place the Network Video Recorder around the heat sources, such as television or oven.
- Do not drop the Network Camera.
- PLEASE NOTE: VIVOTEK does not provide warranty or technical support for third party application software that users additionally install and run on the NR9681.
- Keep the Network Video Recorder away from water. If the Video Recorder is wet, power off immediately.
- Do not place the Network Video Recorder in high humidity environments.
- Do not attempt to remove or uninstall the software on the mounted flash memory.



Avertissement avant installation

- Éteignez rapidement le magnétoscope de réseau s'il dégage de la fumée ou une odeur inhabituelle.
- Ne placez pas le magnétoscope de réseau à proximité d'une source de chaleur, comme un téléviseur ou un four.
- Tenez le magnétoscope de réseau éloigné de la lumière directe du soleil.
- Tenez le magnétoscope de réseau éloigné de l'eau. Si le magnétoscope de réseau est mouillé, éteignez le immédiatement.
- Ne placez pas le magnétoscope de réseau dans un environnement très humide.
- Ne tentez pas de retirer ou de désinstaller le logiciel sur la mémoire flash montée.



Advertencia antes de la instalación

- Apague el Grabador de Video de Red si aparece humo o algún olor no habitual.
- No coloque el Grabador de Video de Red junto a fuentes de calor, como por ejemplo televisores u hornos.
- Mantenga el Grabador de Video de Red alejado de la luz directa del so
- Mantenga el Grabador de Video de Red alejado del agua. Si el Grabador de Video de Red se moja, apáguelo inmediatamente.
- No coloque el Grabador de Video de Red en entornos con mucha humedad.
- No intente quitar o desinstalar el software en la memoria flash montada.

Package Contents / Vérifier le contenu de l'emballage / Compruebe el contenido del embalaje

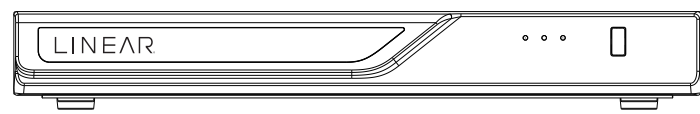

NVR

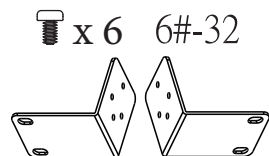

Rack Ears

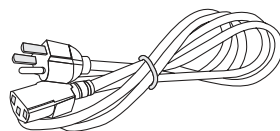

AC Power Cord

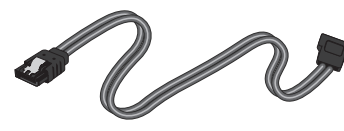

SATA HDD Cable

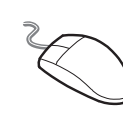

Mouse

x 8 6#-32

HDD Mounting Screws

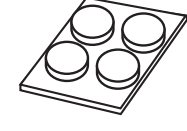

Rubber Feet

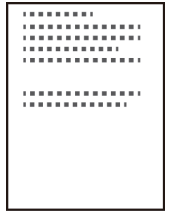

Quick Install Guide

- 1** Apply the rubber feet if NVR will sit on desk or shelf. Not required for rack mounting.

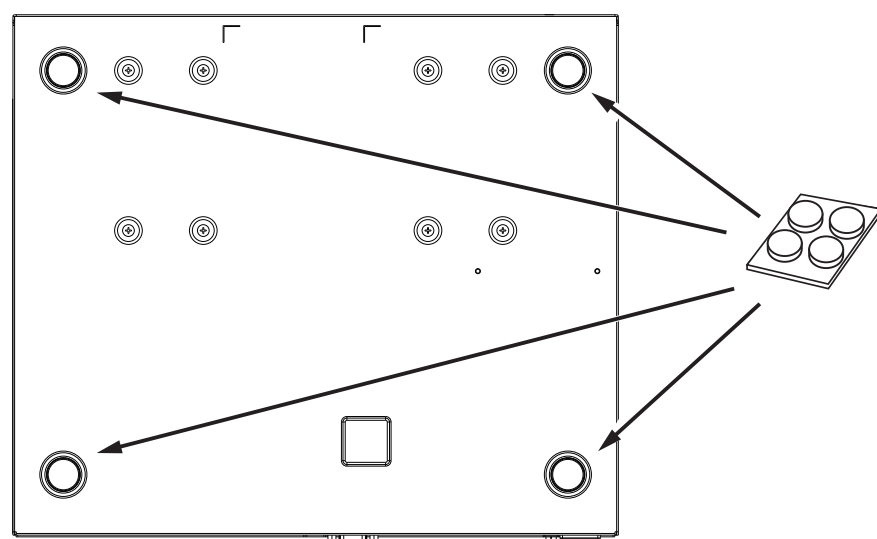

- 2** The NVR can support two Hard Disk Drives. It comes equipped with one HDD to add another HDD follow the below instructions.

Remove the six (6) screws that attach the top cover and slide the cover back to remove.

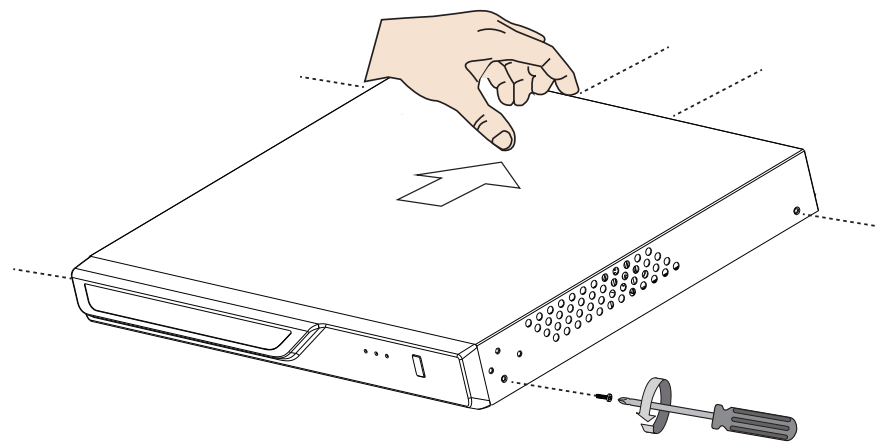

- 3** If adding a second HDD, attach the SATA Data cable to the SATA2 connector on the NVR mother board.

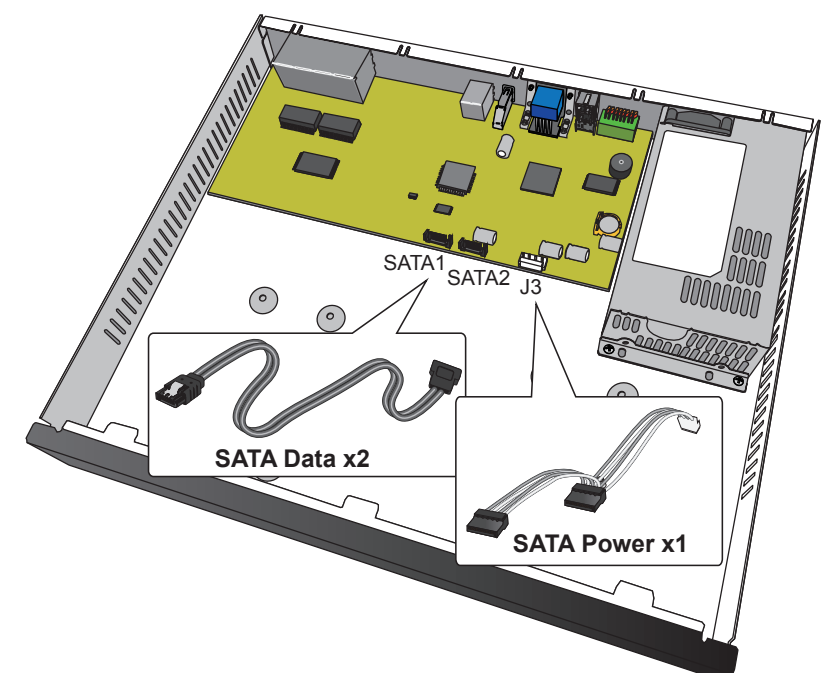

- 4** Attach the SATA Power and Data cables to HDD.

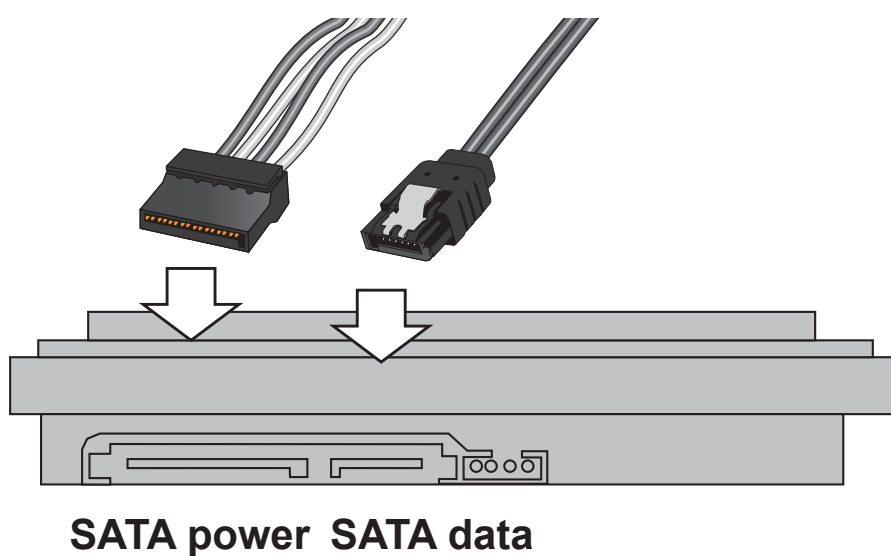

SATA power SATA data

- 5** If adding a second HDD, insert four supplied screws into the HDD (leaving them loose). Position the HDD screws through the large end of the slotted mounting holes on the bottom of the NVR chassis, slide it over, then tighten the mounting screws.

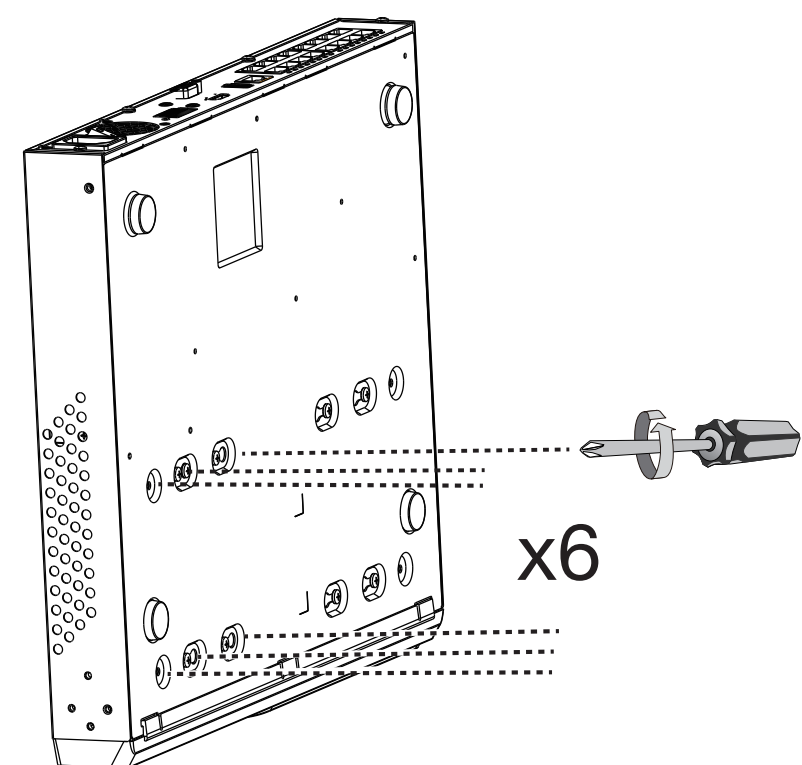
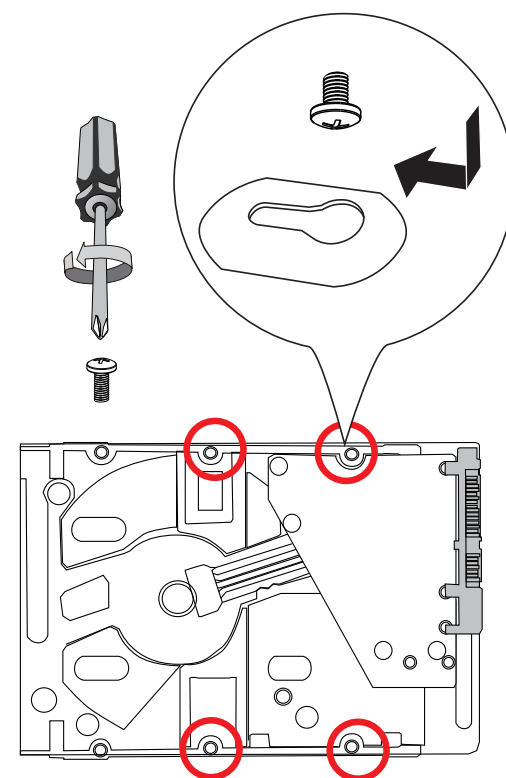

x6

- 6** Reinstall the mounting the cover and the six (6) cover screws.

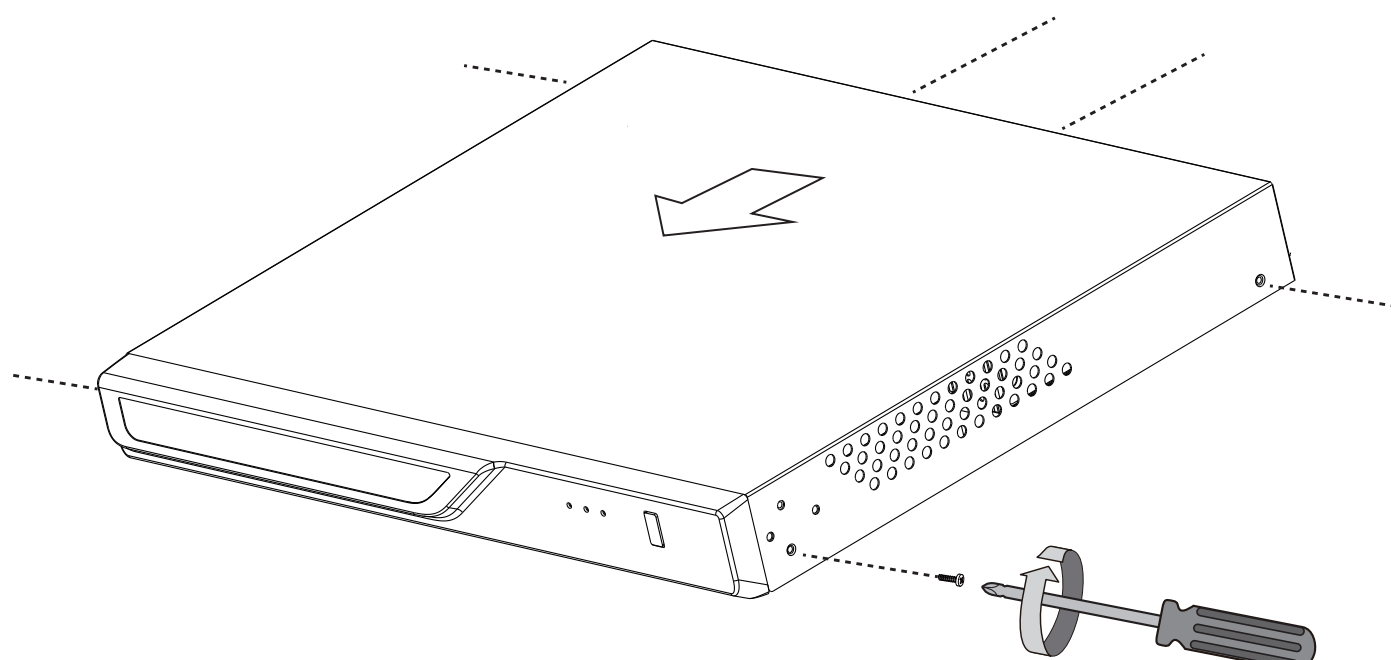

- 8** Secure the Rack Ears to the sides of the chassis by driving three (3) included screws.

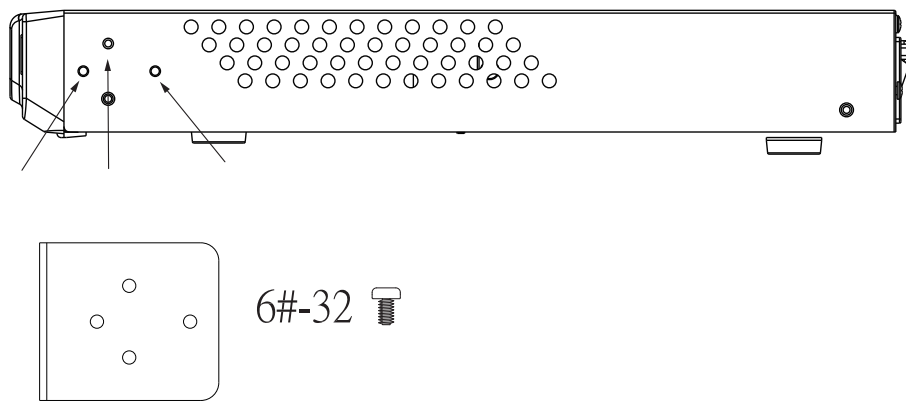

- 9** Secure the chassis to rack posts using two screws on each side.

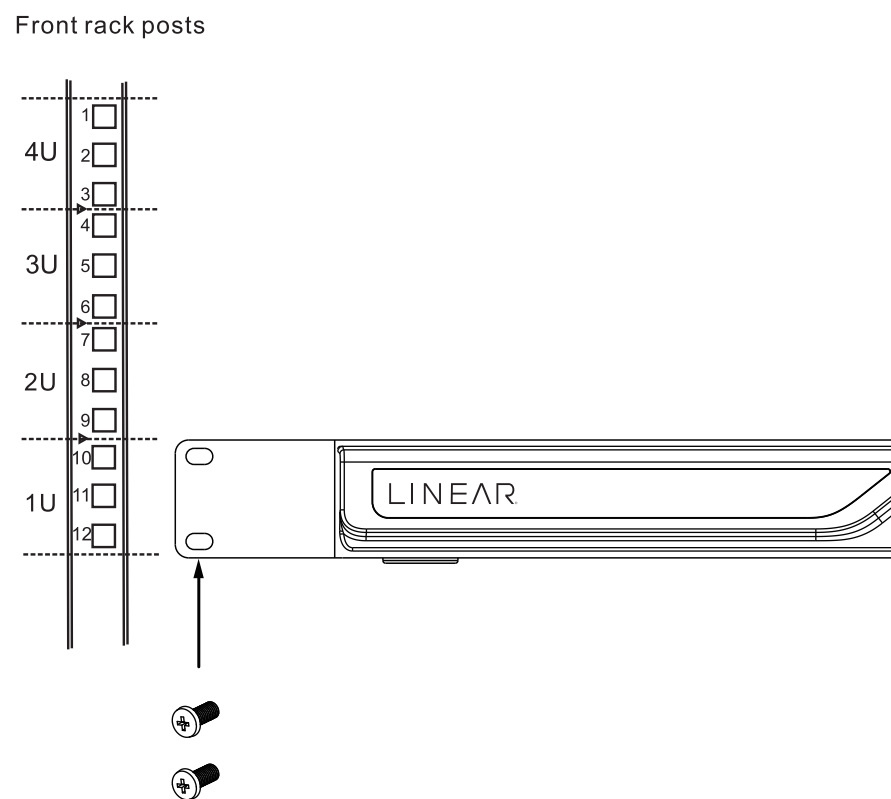

- 10** The front side USB port supports a wired keyboard, mouse or a USB jump drive.

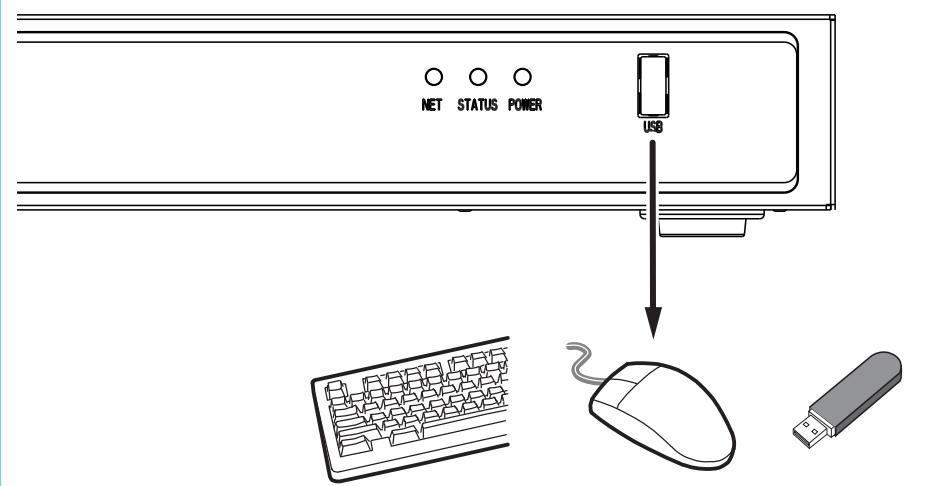

- 11** NVR ports and connections.

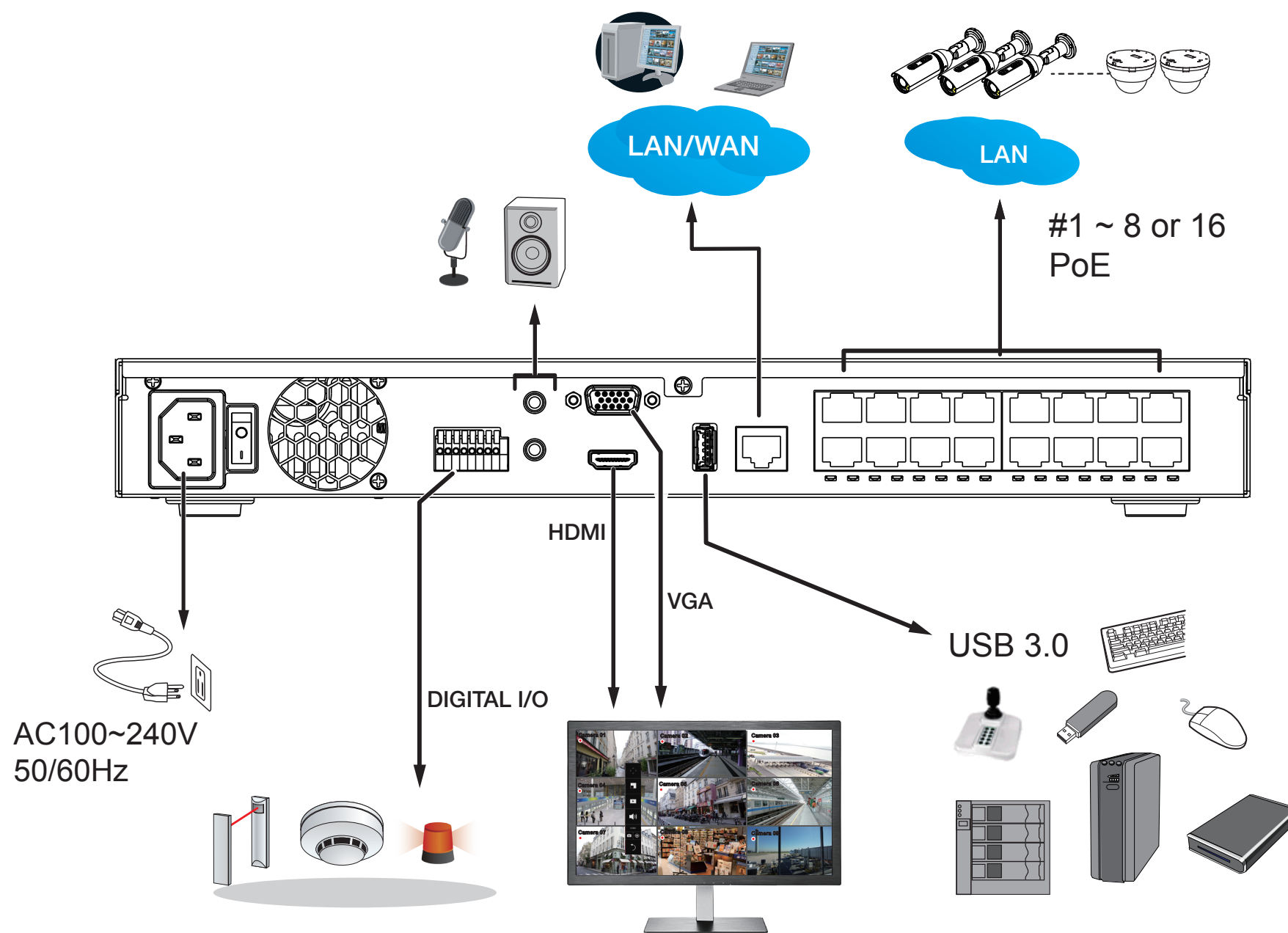

⚡ Please do not connect the NVR's PoE ports to non-PD* devices (such as an Ethernet switch LAN port). The Ethernet control circuits may not be compatible.
* PD = A Powered Device designed to receive power source from a PoE connection such as network cameras.

- 12** Configure using the onboard software.

The NVR comes with a default IP Address of 192.168.0.240. For initial configuration please follow the below instructions:

1. There are two ways to configure the NVR, with a direct Keyboard, Monitor & Mouse connected to the NVR or using a browser to connect to the NVR over a network.

For configuration over the network open browser to the default IP Address of 192.168.0.240

2. At initial boot up you will be prompted to create an Admin password. Once created login to NVR.
3. Login and follow the screen prompts to set, Language, Time Zone, Date and Time. Click "Continue".
4. The system will automatically search and display cameras found on the network. The system will request user name and password for each camera found. Click "Continue".
5. Click on "Setup Gear" to go to setup screen.
6. On setup menu select Globe icon to set IP Address, Subnet, Gateway and DNS appropriate for your network.
7. Navigate the other menu selections for additional setting.
8. Download User Manual from linear-solutions.com/product-manuals/

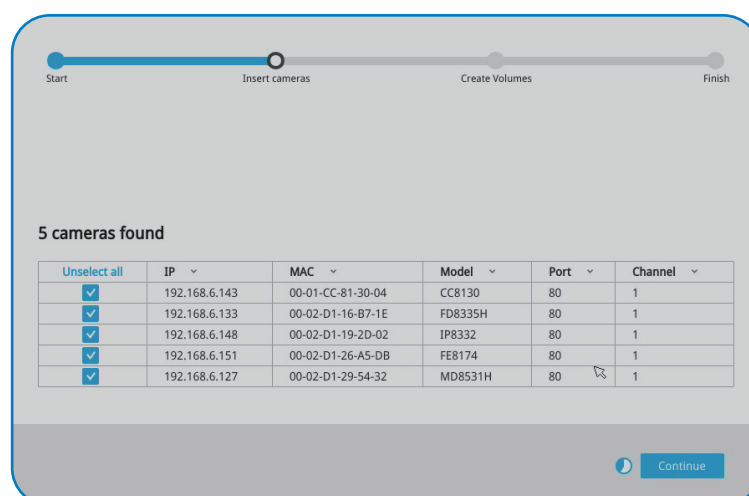
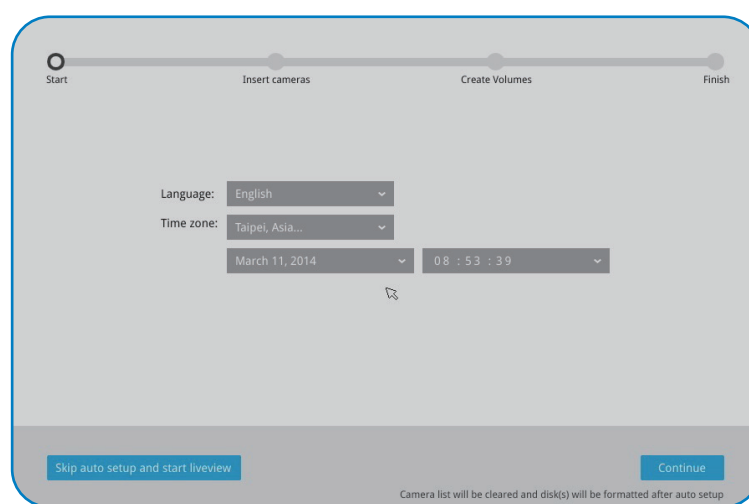

Limited Warranty

This Nortek Security & Control LLC product is warranted against defects in material and workmanship for twenty-four (24) months. This warranty extends only to wholesale customers who buy direct from Nortek or through Nortek's normal distribution channels. Nortek Security & Control LLC does not warrant this product to consumers. Consumers should inquire from their selling dealer as to the nature of the dealer's warranty, if any.

There are no obligations or liabilities on the part of Nortek Security & Control LLC for consequential damages arising out of or in connection with use or performance of this product or other indirect damages with respect to loss of property, revenue, or profit, or cost of removal, installation, or reinstallation.

All implied warranties, including implied warranties for merchantability and implied warranties for fitness, are valid only until the warranty expires. This Nortek Security & Control LLC Warranty is in lieu of all other warranties express or implied.

All products returned for warranty service require a Return Authorization Number (RA#). Contact Nortek Security & Control Returns at 1-855-546-3351 for an RA# and other important details.

LINEAR USA & Canada Toll Free: 800-421-1587
or dial 760-438-7000 | www.linear-solutions.com



©2022 Nortek Security & Control LLC. All rights reserved.
Linear is a registered trademark of Nortek Security & Control LLC.